

K212 Tottenham toilets (Flushaway 2020) – Kingsway Models Christmas Download 2020



Hopefully the gentle task of building this year's download model will enable you to *flush away* all thoughts of the year 2020 ! Printing the pages at 100% will provide the parts for a 1/76 scale model suitable for OO scale models.

The download has three sheets including these instructions.

The sheets with the parts should be printed on thin card (160gsm about the same as a Christmas card will do). Some thicker card (I used mounting board approximately 1.5mm thick) will also be required.

Use a knife and steel rule on a cutting mat to cut the parts out, and Bostik All Purpose adhesive to glue the parts together.

Find previous Christmas downloads on the Kingsway website at <https://www.kingswaymodels.co.uk/free-downloads>

The model depicts the public conveniences that stood outside the Tottenham Hotspur's ground at White Hart Lane in North London. It's probably for this reason that the building had two doorways for 'MEN' and just one for 'WOMEN'. The kit includes different signage if required and also some doors which can be added if you wish to make it more suitable for the modern era. It seems as if the original has been swept away by the building of Tottenham's new stadium. It is quite easy to cut down the depth of the model if you need it to fit into a smaller space.

Note that alternative signed door lintels are supplied to give a more modern look. The centre doorway could have a door added and perhaps be signed as 'Accessible'.

1. Cut out the front wall from sheet 1. Glue this to some thick card. Carefully cut out the window openings. Colour the edges of the doorways and windows with a soft 3B pencil. Cut out the three lamps and glue in place over each doorway.
2. Cut out the Pediment backing and glue to thick card and then glue to the rear of the front wall. C. Cut out the two printed windows from sheet 2 and glue inside the building behind the window openings.
3. Cut out the floor from sheet 1 and glue to thick card (mark the 'FRONT' on the underside). Glue the floor to the rear of the front wall. Cut out two of the outer (brick walls) from sheet 2. Glue these to thick card. The walls will need to be cut to match the length of the floor. Glue to the rear of the front wall and edges of the floor.
4. Cut out the outer rear wall from sheet 1. Glue to thick card and *then glue the inner rear wall to the other side*. Glue the wall to the rear of the side walls and floor. Cut out two brick side walls from sheet 2. Glue these **thin** pieces to each side of the building neatly covering the edges of the front and rear walls.
5. Glue the grey 'capping strips' to thick card in one lot. Cut out one of the strips and colour the edges. Use this to cap the top of the front wall by cutting into short strips to size. For the final curved section, cut a strip approx 30mm long and curve between fingers. Check and cut to size before glueing in place.
6. Cut out the 'internal cross wall' and glue to thick card. Cut out 4 small sections of remaining brick wall from sheet 2, each approx. 15mm wide. Glue these to thick card and reduce their height to match the 'cross wall'.
7. Glue the brick walls and cross wall in place as shown in the picture. (Right ➡)
8. The layout of the interior of the building is unknown to me! It would make an interesting project. I simply put a length of dividing wall between the two areas, centrally down the building.
9. Cut out the roof and glue to thick card. Carefully cut this to size so that it fits between the walls of the building. It can rest on the cross wall and dividing wall.
10. Cut out more grey capping strips and after colouring the edges, glue to the tops of the side and rear walls.
11. Add the rooflights as required. I coloured the edges black and raised them slightly with an off-cut of thick card underneath. Merry Christmas everyone, let's now Flushaway 2020 forever!

Each 15mm wide section of wall needs to be trimmed to match the height of the 'cross wall'.

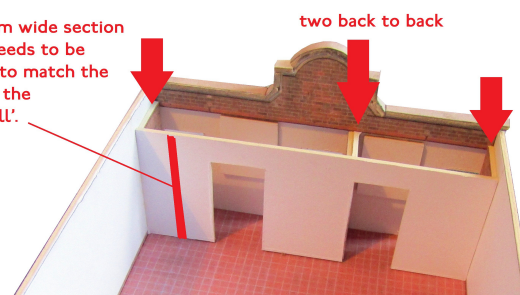

KINGSWAY

Merry Christmas from Kingsway Models.
Find a large range of distinctive card building kits for sale at
www.kingswaymodels.co.uk

Designed by John Howe November 2020



LAMPS

WOMEN

CUT OUT

FRONT WALL

MEN

CUT OUT

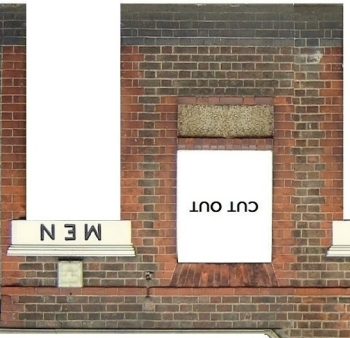

PEDIMENT BACKING



DOOR

OPTIONAL



WALL CAPPING

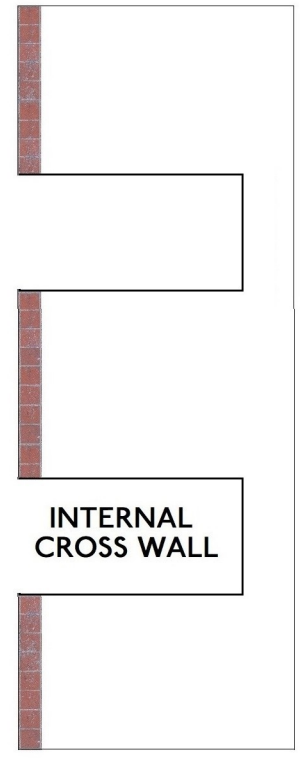

INTERNAL CROSS WALL

FRONT

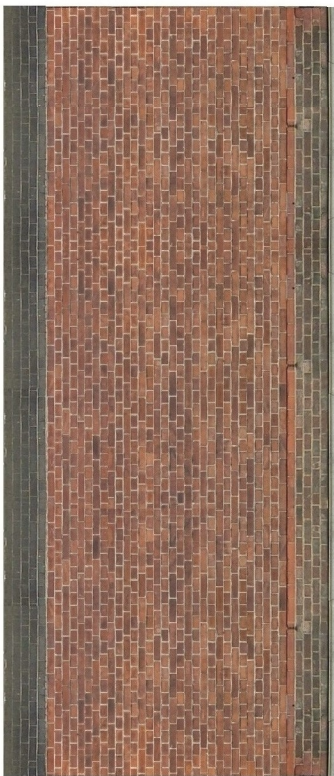

REAR WALL OUTER

FRONT

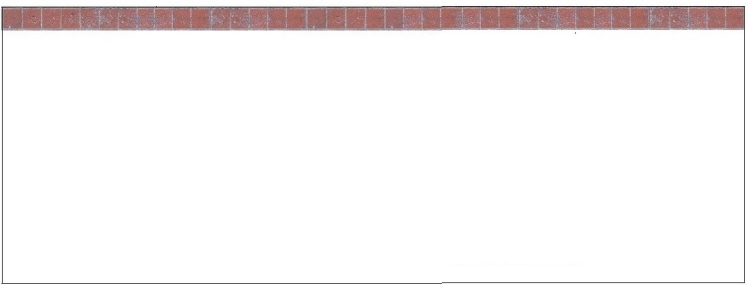

REAR WALL INNER

1

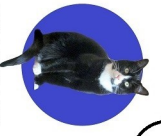

KINGSWAY

FLUSHAWAY

2020



GENTLEMEN

LADIES

WOMEN

MEN

ACCESSIBLE

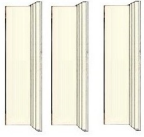

ROOFLIGHTS

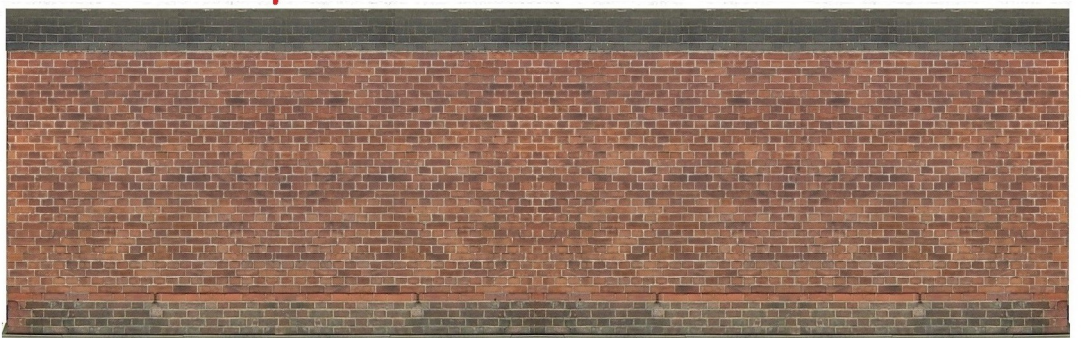
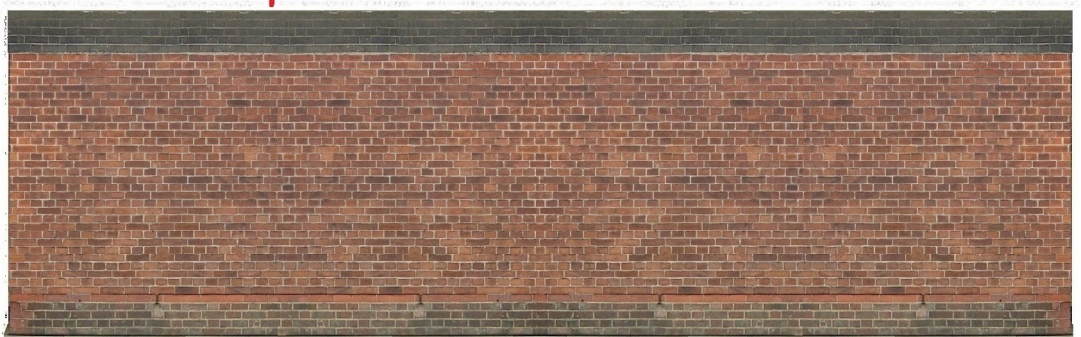
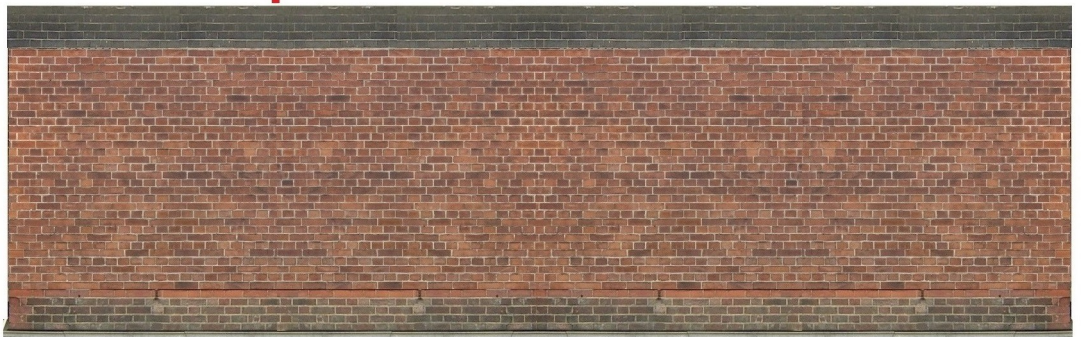

Cut to match floor length approximately to red mark

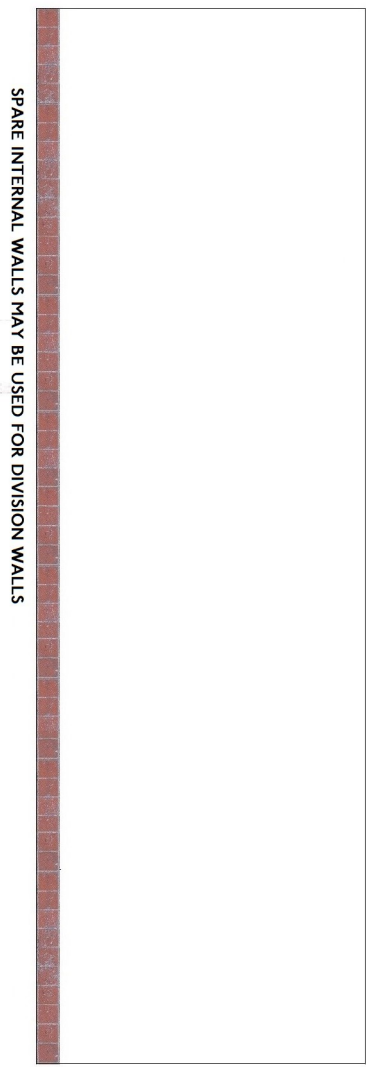

SPARE INTERNAL WALLS MAY BE USED FOR DIVISION WALLS